

STARITE PUMP PARTS

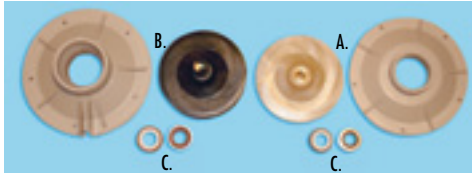

A. Models P2RA & PEA

| HP | Impeller | Price | Diffuser | Price |
|-------|--------------|---------|----------|---------|
| 1/2 | C105-92PR | \$43.54 | C1-217P | \$18.18 |
| 3/4 | C105-92PS | \$43.54 | C1-216P | \$18.41 |
| 1 | C105-138PEB | \$46.53 | C1-200PA | \$19.53 |
| 1 1/2 | C105-137PEB | \$57.20 | C1-200PA | \$19.53 |
| 2 | C105-137PDBA | \$57.20 | C1-200PA | \$19.53 |

B. Models P4RA, P4EA, P6RA & P6EA

| HP | Impeller | Price | Diffuser | Price |
|-------|--------------|---------|----------|---------|
| 1 | C105-238P | \$48.96 | C1-271PI | \$19.98 |
| 1 1/2 | C105-238PB | \$48.96 | C1-271PI | \$19.98 |
| 2 | C105-238PDBA | \$50.45 | C1-271P | \$19.31 |
| 2 1/2 | C105-238PEBA | \$50.45 | C1-271P | \$19.31 |
| 3 | C105-238PLA | \$52.45 | C1-271P | \$19.31 |

C. SHAFT SEALS

| Part No. | Pump Model No. | Price |
|--------------------------|--|---------|
| U109-93SS ¹ | PE, PEA, P2R, P2RA | \$14.58 |
| 17304-0100S ² | PE, PEA, P2R, P2RA | \$8.15 |
| U109-372SS ¹ | P4E, P4EA, P4R, P4RA, P6R, P6RA, P6E, P6EA | \$21.44 |
| 37400-0028S ² | P4E, P4EA, P4R, P4RA, P6R, P6RA, P6E, P6EA | \$24.28 |

¹ Models with copper inserts pre-1998

² Models without copper inserts beginning 1998

D. SEAL/GASKETS KITS

Includes shaft seal, gaskets, and o-rings.

| Part No. | Pump Model No. | Price |
|---------------------|----------------------|---------|
| PP1000 ¹ | PE, PEA, P2R, P2RA | \$30.94 |
| PP4000 ¹ | P4E, P4EA, P4R, P4RA | \$36.29 |
| PP1200 ² | PE, PEA, P2R, P2RA | \$30.94 |
| PP4200 ² | P4E, P4EA, P4R, P4RA | \$36.29 |

¹ Models with copper inserts pre-1998

² Models without copper inserts beginning 1998

E. TRAP LID KITS

Includes trap lid and o-ring.

| Part No. | Pump Model No. | Price |
|----------|----------------------|---------|
| PP2075 | PE, PEA, P2R, P2RA | \$41.69 |
| PP4075 | P4E, P4EA, P4R, P4RA | \$44.48 |



WHISPER FLO PUMP PARTS

A. Impellers

| Part No. | Models | HP | Price |
|----------|----------------|-------|---------|
| 07-3126 | WFE-2, WFK-2 | 1/2 | \$62.55 |
| 07-3127 | WFE-3, WFK-3 | 3/4 | \$62.55 |
| 07-3128 | WFE-4, WFK-4 | 1 | \$62.55 |
| 07-3129 | WFE-6, WFK-6 | 1 1/2 | \$62.55 |
| 07-3130 | WFE-8, WFK-8 | 2 | \$62.55 |
| 07-3131 | WFE-12, WFK-12 | 3 | \$62.55 |

- B. #07-2927 Diffuser 1/2 - 2HP \$47.63
 #07-2928 Diffuser 3HP only. . . . \$56.95
 C. #07-1734 Shaft Seal \$16.34
 D. #07-1444 Diffuser O' Ring (not shown) . . \$3.85
 E. #35-7102 Housing Gasket. \$3.92
 F. #35-7149 Volute Replacement Kit . . \$188.19
 G. #35-0201 Seal Plate Kit \$128.70
 H. #07-0387 Basket \$12.04
 I. #35-0013 Lid O' Ring (not shown) . . . \$1.94

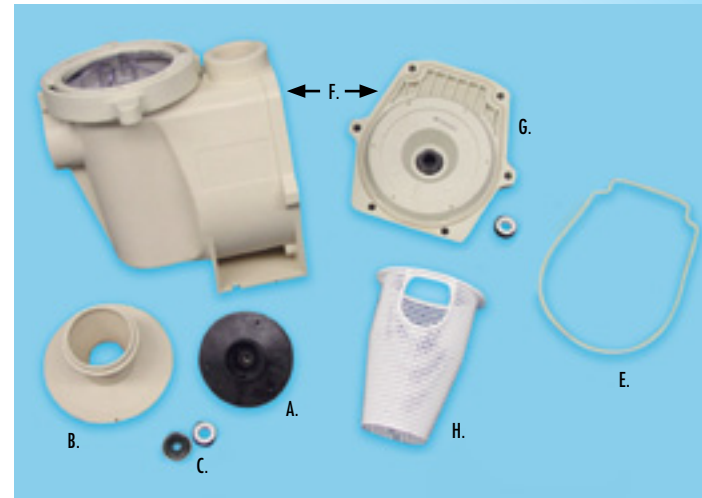

- F. #C176-59P Tank Body Assembly (P4 Series) . \$176.29
 G. #17307-0110S Tank Body Assembly (P6 Series) \$194.36
 H. #C108-33P Basket \$7.99
 I. #C8-58P Basket \$8.62
 J. #C19-37A Clamp Only \$65.25
 K. #PKG115 Trap Assembly (P2 Series) \$90.11



- L. #C203-193P Seal Plate Kit (P2 Series) \$104.74
 #C203-194P Seal Plate Kit (P4 Series) \$104.74
 M. #C176-47P1 Tank Body. \$83.41
 N. #WC36-22 Hand Knob \$8.28
 O. #U178-920P* Drain Plug with O-Ring . \$2.08
 *Parts not shown



PUMP PARTS

CHALLENGER PUMP PARTS

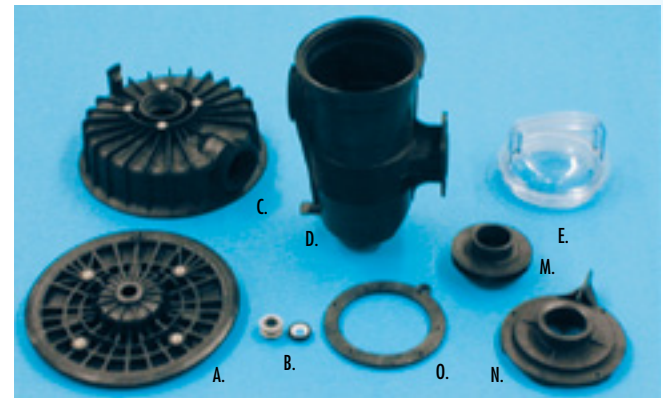

| Part No. | Description | Price | Part No. | Description | Price |
|-------------|------------------------|---------|-------------|--------------------------|---------|
| A. 35-5303 | Seal Plate | \$63.68 | G. 35-5030* | Diffuser "O" Ring | \$5.87 |
| B. 35-4545 | Seal 5/8 Mech. | \$14.29 | 35-5331* | Diffuser "O" Ring (3 HP) | \$1.04 |
| C. 35-5468 | Front Housing | \$92.93 | H. 35-5329* | Front Housing "O" Ring | \$10.51 |
| D. 35-5300 | Strainer Pot | \$91.62 | I. 15-4699* | Drain Plug | \$4.34 |
| E. 35-5301 | Strainer Lid | \$40.34 | J. 19-2115* | Drain Plug "O" Ring | \$7.99 |
| F. 35-5389* | Impeller Locking Screw | \$5.99 | K. 35-0013* | Lid "O" Ring | \$1.94 |
| | | | L. 35-5318* | Basket | \$25.72 |

M. IMPELLER

| Model No. | Cat. No. | Price |
|---------------|----------|---------|
| CF11-N1-3/4A | 35-5043 | \$34.09 |
| CF11-N1-1A | 35-5067 | \$34.76 |
| CF11-N1-11/4A | 35-5074 | \$35.18 |
| CF11-N1-2A | 35-5086 | \$35.44 |
| CH11-N1-3FE | 35-5544 | \$46.26 |
| CF11-N1-5FE | 35-5068 | \$34.76 |

N. DIFFUSER

| Model No. | Cat. No. | Price |
|---------------|----------|---------|
| CF11-N1-3/4A | 35-5029 | \$25.34 |
| CF11-N1-1A | 35-5029 | \$25.34 |
| CF11-N1-11/4A | 35-5077 | \$25.34 |
| CF11-N1-2A | 35-5077 | \$25.34 |
| CH11-N1-3FE | 35-5545 | \$58.32 |
| CF11-N1-5FE | 35-5069 | \$23.45 |

O. MOUNTING PLATE

| Model No. | Cat. No. | Price |
|---------------|----------|---------|
| CF11-N1-3/4A | 35-5028 | \$14.85 |
| CF11-N1-1A | 35-5028 | \$14.85 |
| CF11-N1-11/4A | 35-5078 | \$9.34 |
| CF11-N1-2A | 35-5078 | \$9.34 |
| CH11-N1-3FE | 35-5317 | \$9.34 |
| CF11-N1-5FE | 35-5495 | \$8.62 |

*Parts not shown